

# DISTRICT DEPARTMENT OF TRANSPORTATION

Welcome!

Thank you for joining us.

We will be getting started shortly...



***Rehabilitation of Eastern Avenue, NE***  
***(from New Hampshire Avenue, NE to Whittier Street, NW)***



# PUBLIC MEETING AGENDA

- Introduction of Project Team Members
- Project Background / Corridor Deficiencies
- Project Objectives
- Roadway / Corridor Improvements
- Intersection Improvements
- Retaining Wall Rehabilitation
- Drainage Improvements
- Landscaping
- Construction Phasing
- Detours
- Schedule
- Stakeholder Feedback
- Q&A



## Project Team Members

Zahra Dorriz, DDOT

Yvonne Thelwell, DDOT

Tesfalem Aim, DDOT

Alberta Paul, DDOT

Christian Pineiro, DDOT

Vien Thai, Century Engineering

Neil Robinson, Century Engineering

Stacee Hemby, TB&A

# Project Location Map

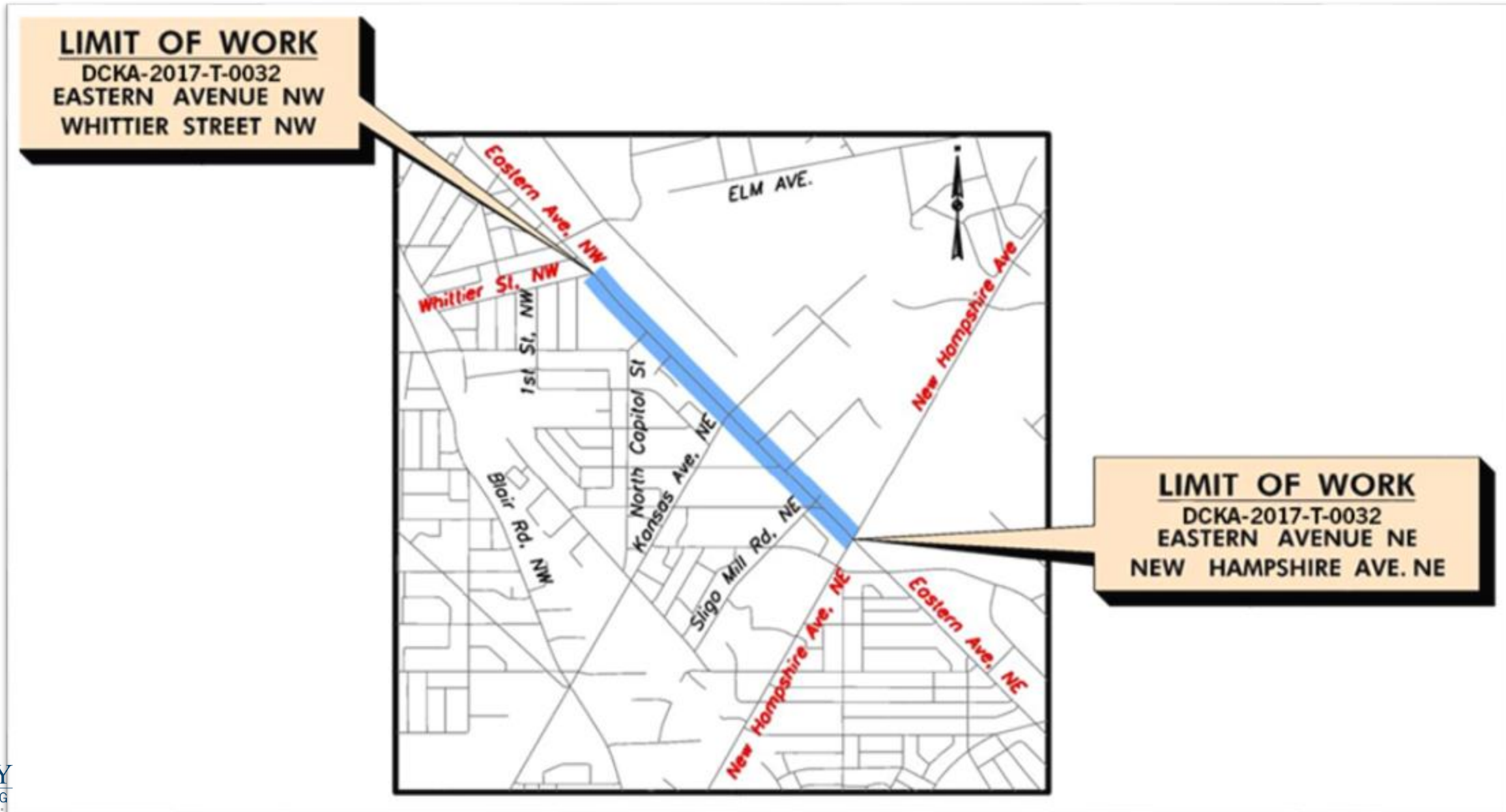



# Project Background/Corridor Deficiencies

## ➤ Roadway Classification/Geometrics/Condition

- Inadequate lane transition (4-lane minor arterial to 2-lane)
- Deteriorating pavement and curbs

## ➤ Traffic Operations/Speed

- High Speeds
- Improper lane use
- No left-turn lane

## ➤ Pedestrian/Bicycle Facilities and Operations

- Unsafe unsignalized Pedestrian Crossing
- Limited sight distance
- No sidewalks or Pedestrian access to bus stops
- Non-compliant Pedestrian curb ramps



# Project Background/Corridor Deficiencies (cont'd.)

## ➤ Traffic Control Devices

- Deteriorated signs/sign clutter & improper placement
- Poor lane delineation
- Inadequate roadway lighting

## ➤ Retaining Walls

- Tilting and crumbling retaining walls

## ➤ Drainage

- Damaged/clogged inlets (sediment, debris)
- Reduced capacity of stormdrain pipes
- No Stormwater Management facility
- Flooding

## ➤ Landscaping/Visual Appeal/Neighborhood Appearance

- Unhealthy trees
- Improper tree-pruning and maintenance



# Project Objectives

- **Improve Roadway Safety**
  - Reconstruct deteriorated roadway infrastructure
  - Upgrade traffic signals and reduce speeding
  - Improve the storm drainage system
- **Improve Pedestrian Safety**
  - Add new sidewalk
  - Improve pavement markings and signage
  - Reconstruct non-ADA compliant features
- **Improve Bicycle Safety**
  - Add a bike lane (with buffer area whenever possible)
  - Improve pavement markings
- **Improve the corridor's appearance and functionality**
  - Add new granite curbs
  - Upgrade streetlights
  - Add bioretention facilities and trees





# Roadway / Corridor Improvements

## General Project Improvements

- 0.61 miles of full-depth pavement reconstruction (Whittier St, NW to New Hampshire Ave, NE)
- 1,500 ft. of new 6 ft. sidewalk with 6 ft. grass buffer (NB Eastern Ave, NE)
- Introduce bike lane and new 8 ft. Shared-Use Path (just south of North Capitol St, NW)
- Construct new granite curbs (entire project length)
- Modification of traffic signals and addition of a new one
- Improve Streetlights (the entire length)
- Major stormwater drainage system improvements

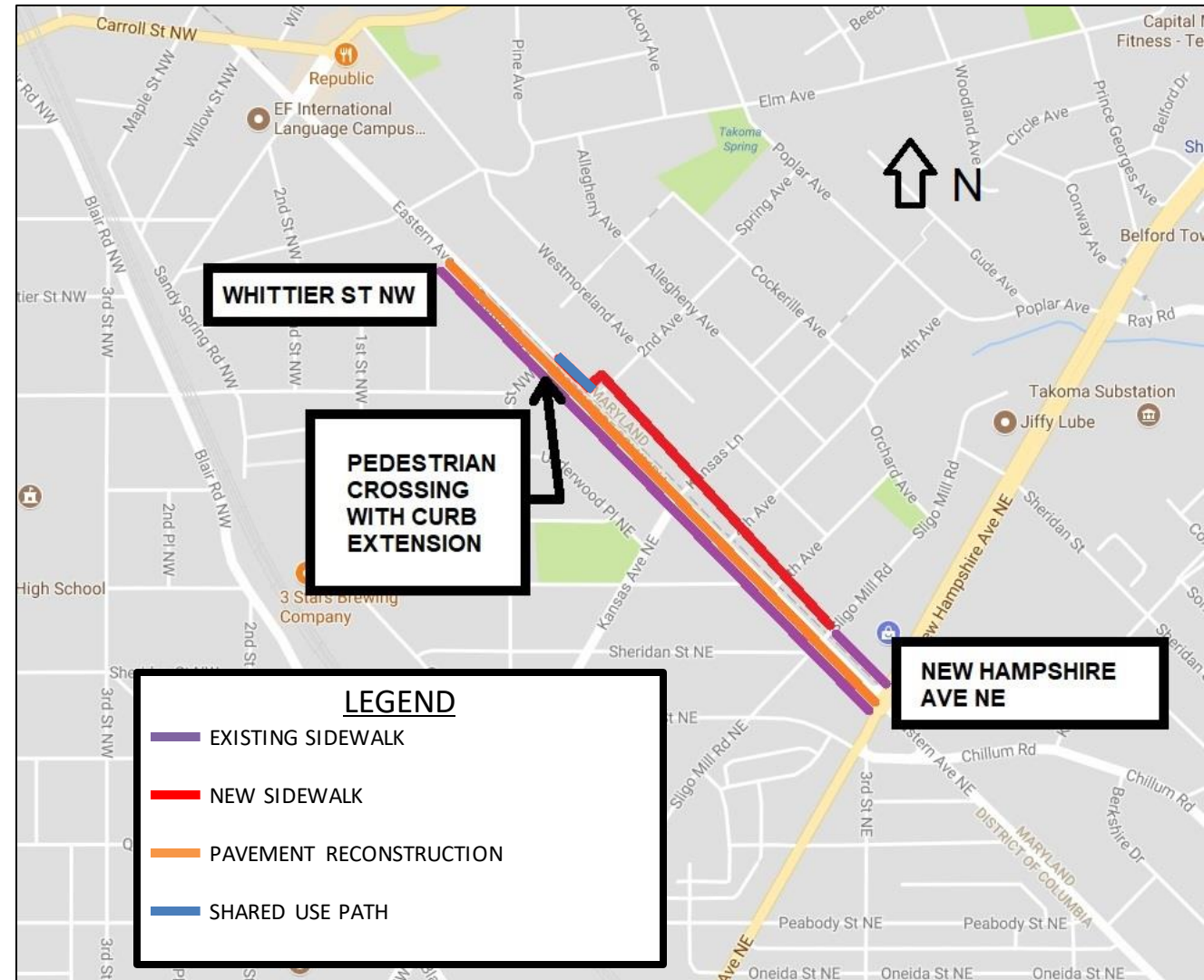



# Roadway / Corridor Improvements (cont'd.)

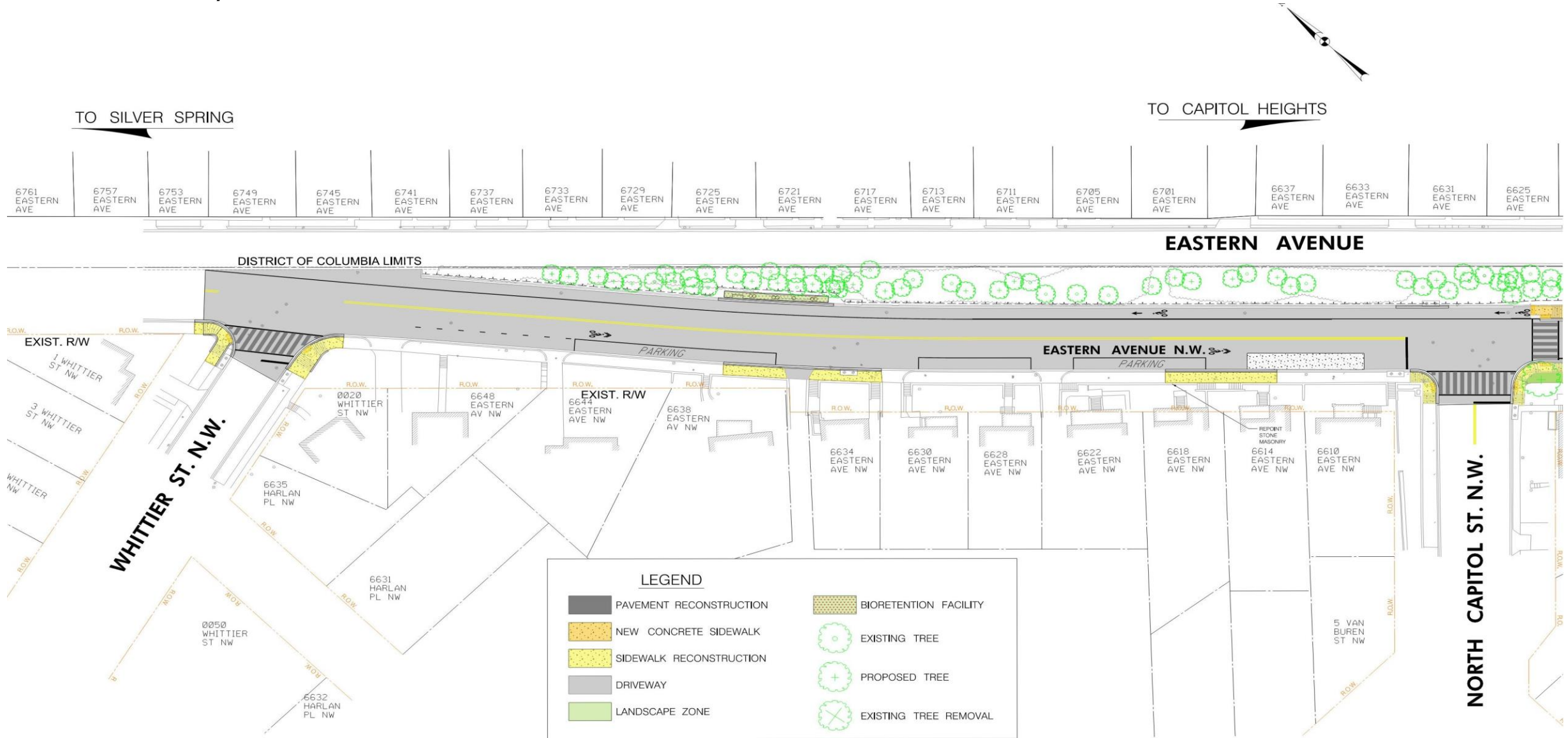

# Roadway / Corridor Improvements (cont'd.)

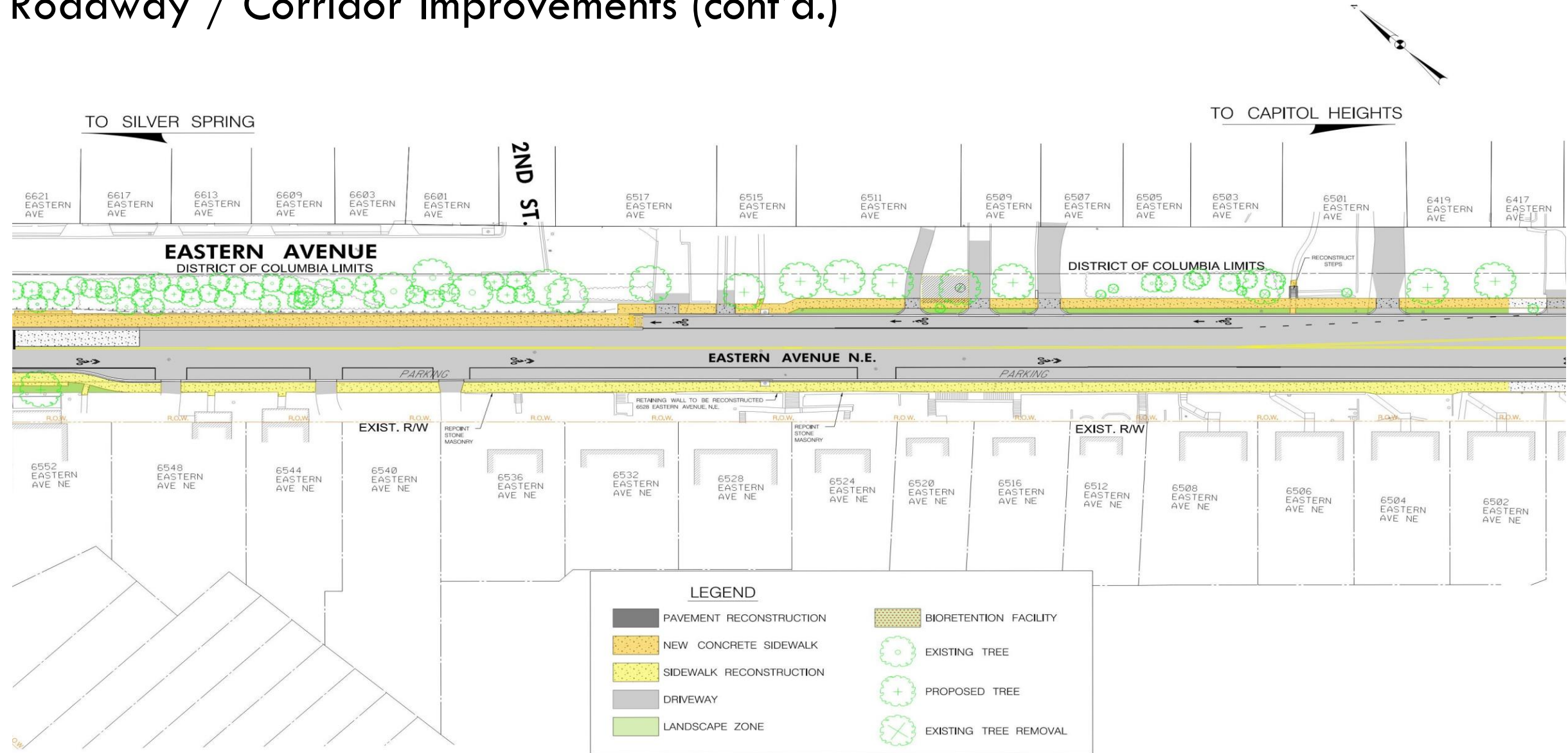

# Roadway / Corridor Improvements (cont'd.)





# Roadway / Corridor Improvements (cont'd.)

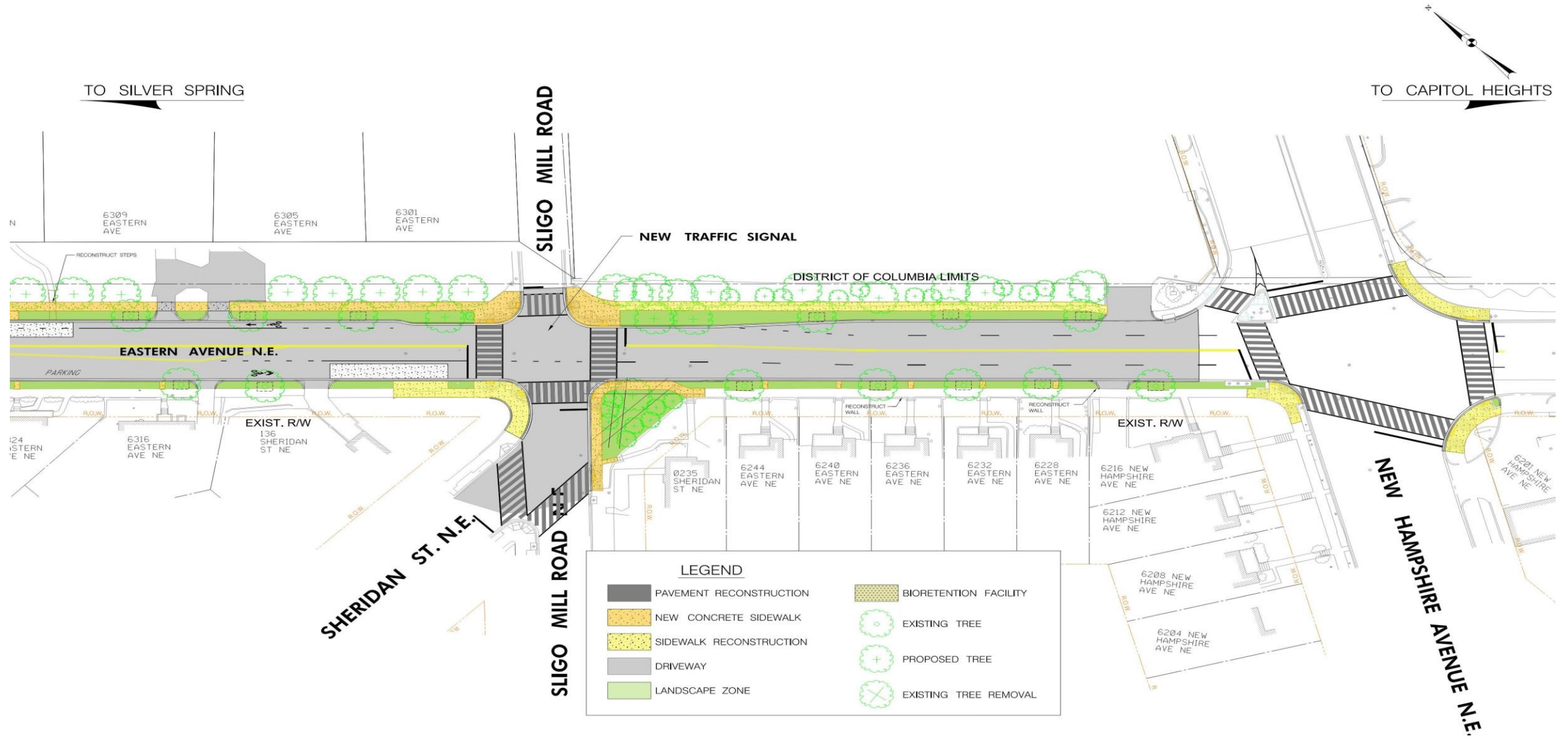



# Roadway / Corridor Improvements

- Roadway Safety
- Traffic Operations & Safety
- Roadside Safety
- Pedestrian & Bicyclist Safety
- Neighborhood Safety



# Roadway / Corridor Improvements (cont'd.)

## Roadway Safety Improvements

- Reconstruct deteriorated roadway
- New bus pads
- Reconstruct drainage infrastructure
- Re-stripe roadway to eliminate extra-wide lanes
- Bump-outs for traffic calming
- Reduced lane-widths and bump-outs lower vehicle speeds closer to 25 MPH speed limit
- Facilitates safer bicycle operations
- Improved safety for all road users

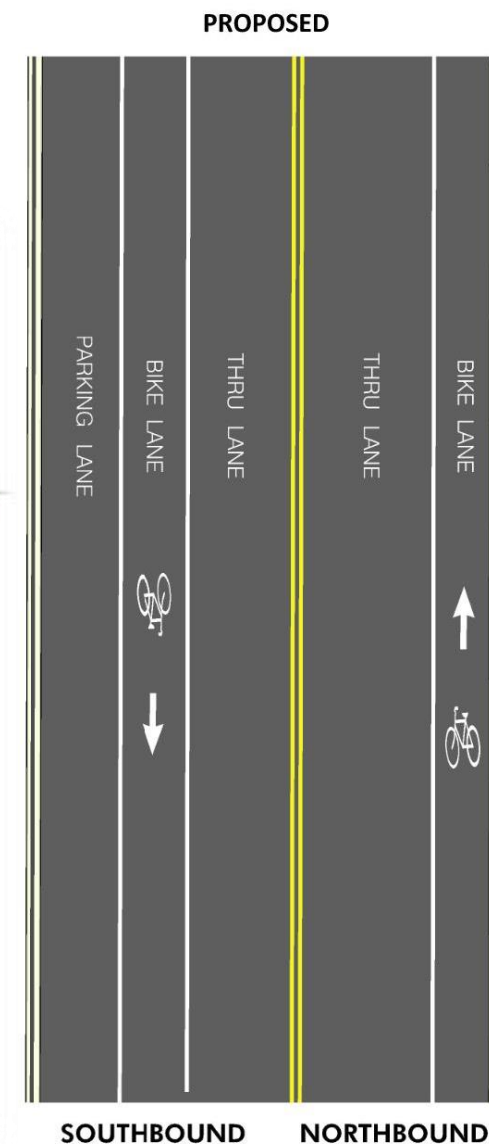
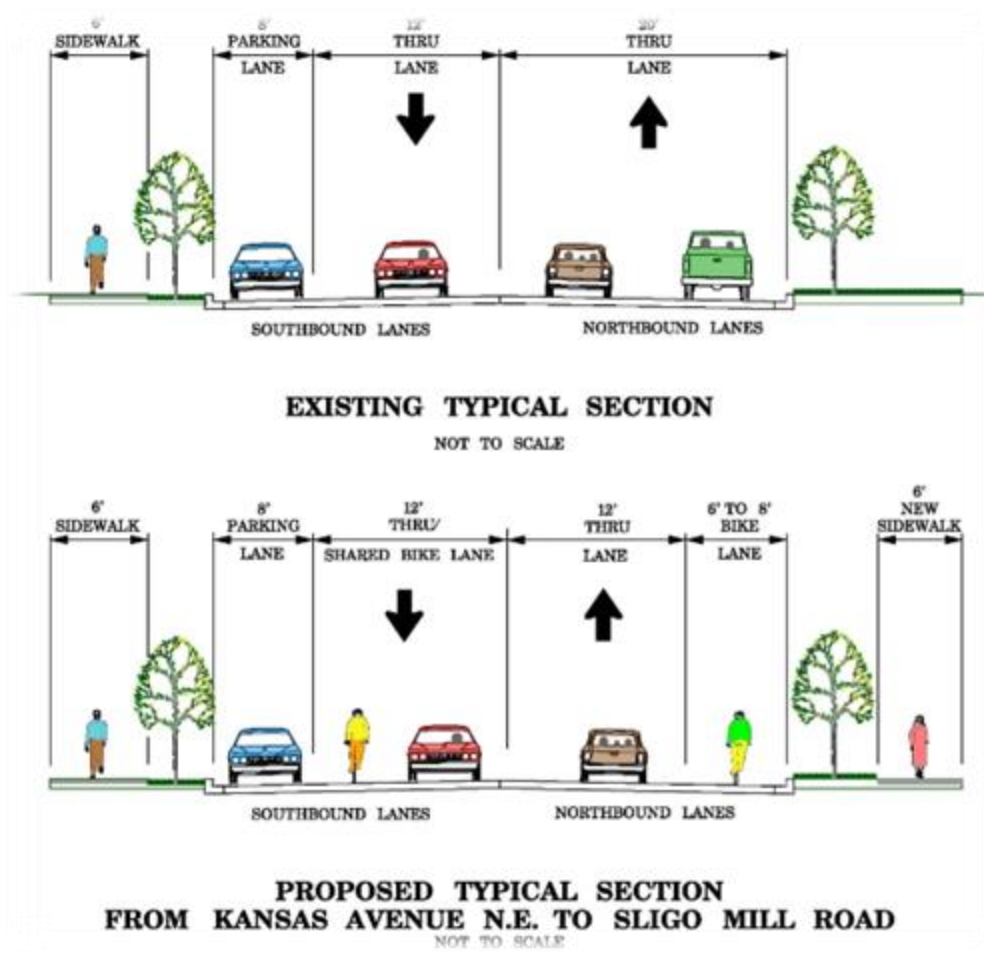



# Roadway / Corridor Improvements (cont'd.)

## Traffic Operations & Safety Improvements

- Install bump-outs at intersections for traffic calming / speed reduction
- Install bump-outs to shorten pedestrian crossing distance
- Install bump-outs to increase pedestrian visibility to motorists
- Install high-visibility Continental-style crosswalks
- Improved safety for all road users



# Roadway / Corridor Improvements (cont'd.)

## Roadside Safety Improvements

- Rehabilitate deteriorating landscape and retaining walls
- Replace / install new guardrail
- Upgrade deteriorating curb & gutter with granite curb
- Upgrade street lighting
- Upgrade existing curb ramps, sidewalks, bus stops to meet ADA standards
- Relocate bus stops to accommodate new sidewalks





# Roadway / Corridor Improvements (cont'd.)

## Pedestrian & Bicyclist Safety Improvements

- Shared-use path
- Bike lanes
- Shared Lanes (Sharrows)
- Sidewalks

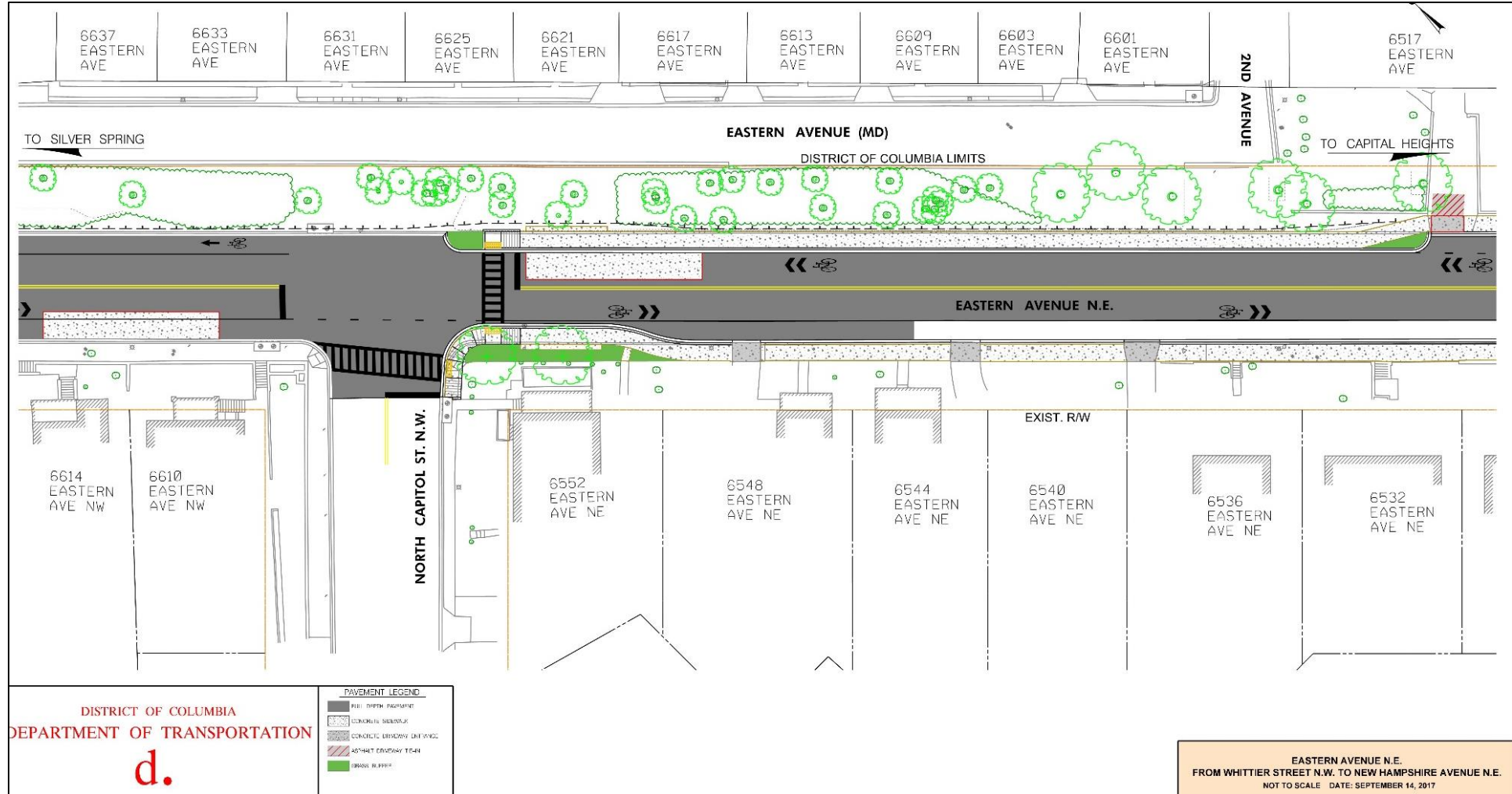

# Intersection Improvements (Kansas Ave, NE)

## Traffic Signal (RECON)

- Accessible Signal
- ADA-compliant ramps
- Intersection lighting
- Signing
- Pavement Markings
- Continental X-walks
- Dedicated turn-lane
- Veh. Video Detection

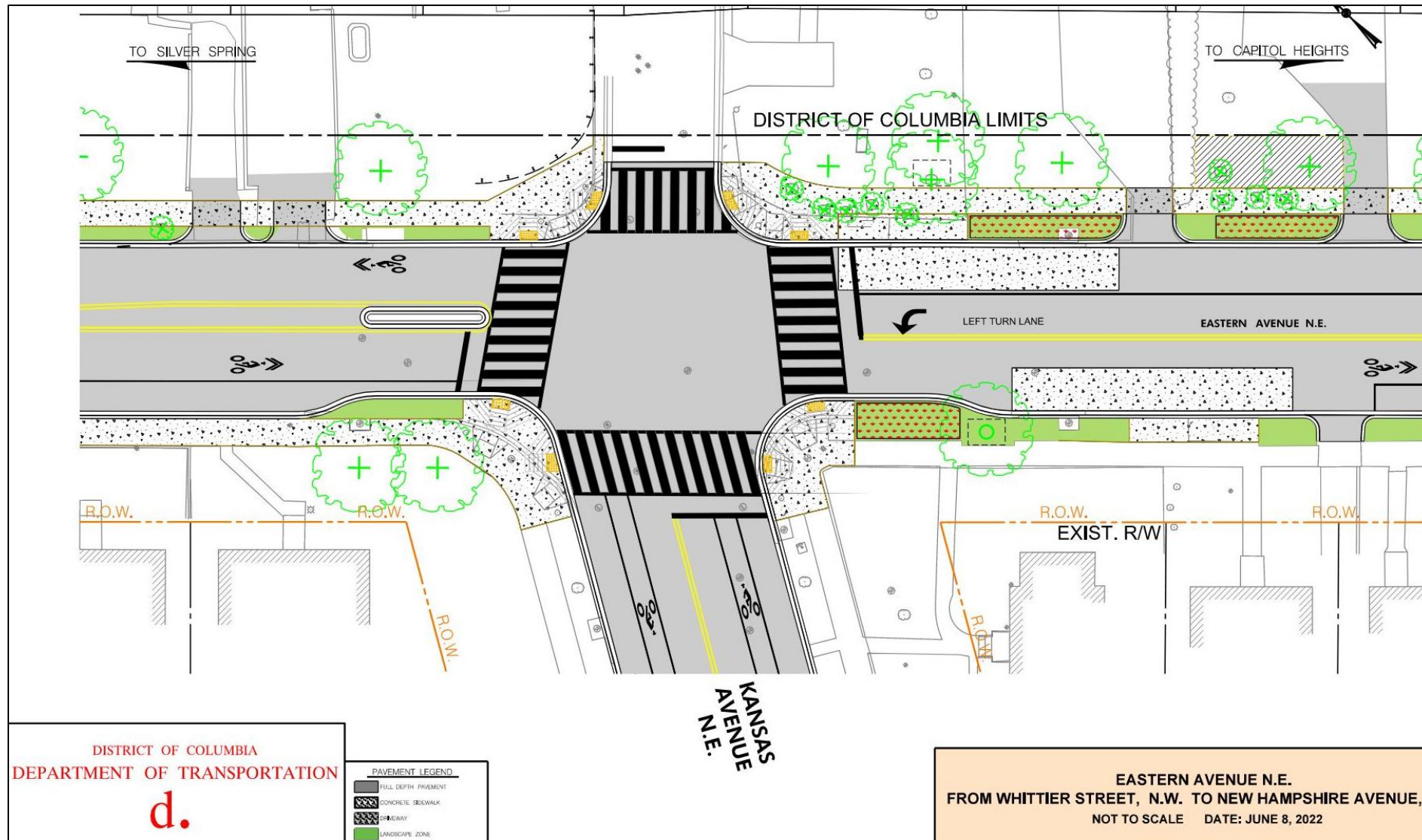



# Intersection Improvements (Sligo Mill Rd, NE)

## Traffic Signal (NEW)

- Interim Signal (2022)
- ADA-compliant ramps
- Intersection lighting
- Signing
- Pavement Markings
- Continental X-walks
- Dedicated turn-lane
- Veh. Video Detection
- Ultimate signal with corridor improvements

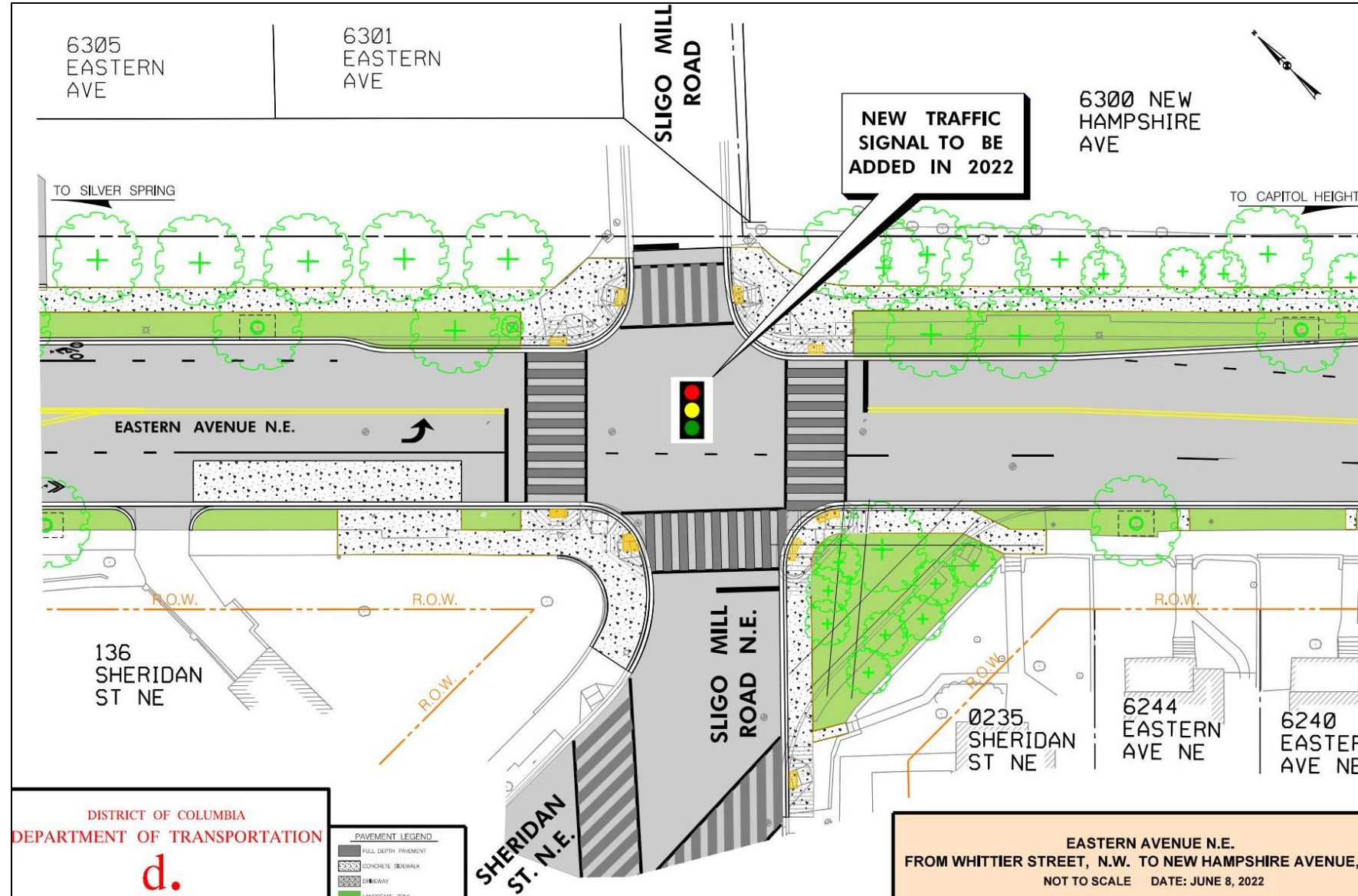

# Intersection Improvements (New Hampshire Ave, NE)

## Traffic Signal (RECON)

- Accessible Signal
- ADA-compliant ramps
- Intersection lighting
- Signing
- Pavement Markings
- Continental X-walks
- Veh. Video Detection
- Channelizing Island

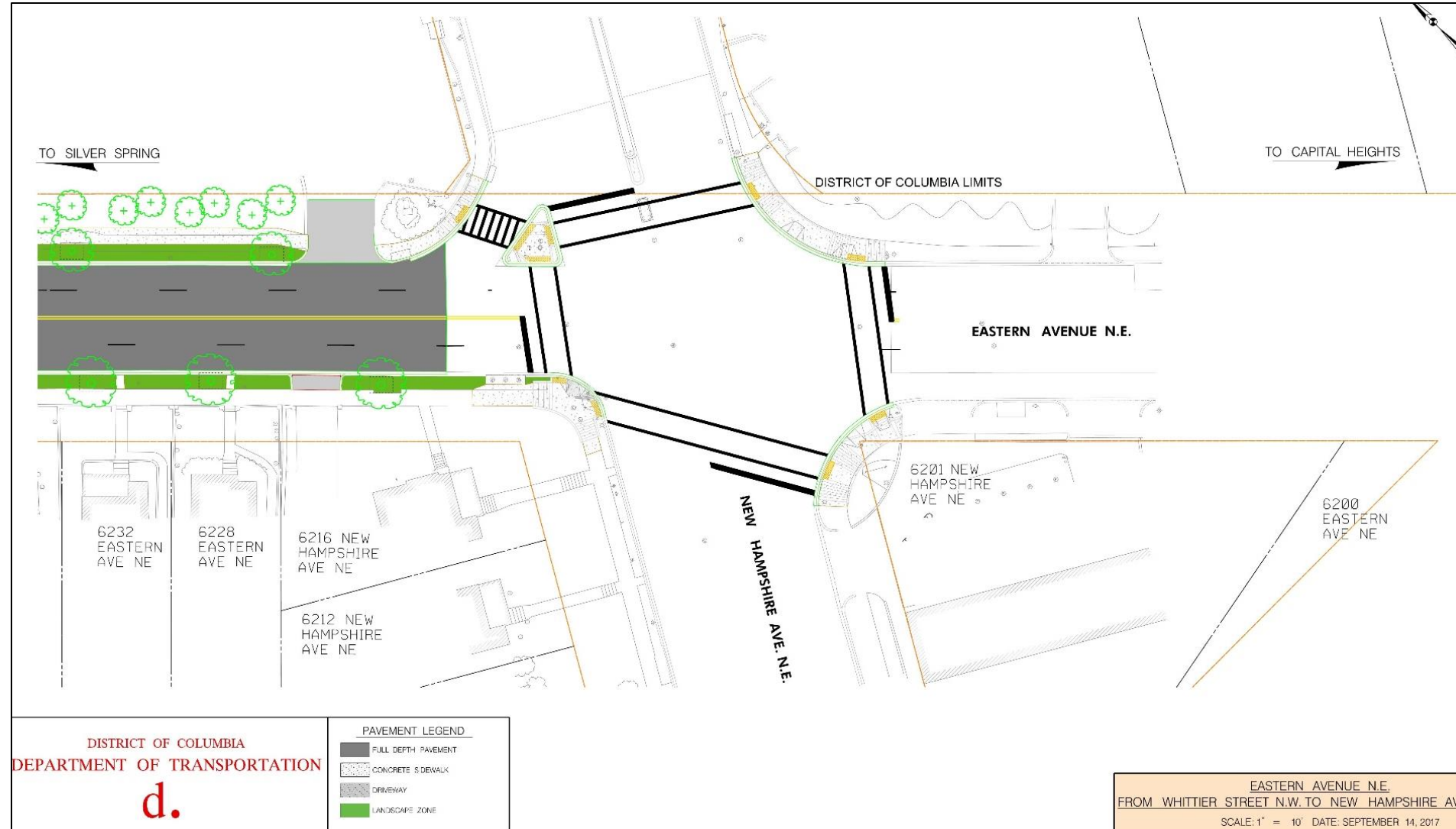



# Retaining Wall Rehabilitation

## Deteriorating Retaining Walls

- Tilting
- Crumbling
- Remedial design



GRANITE BLOCKS REPLACED



BRICK WALLS REPOINTED



GRANITE BLOCKS REPOINTED



LOW BRICK WALLS REPLACED IN-KIND



BRICK WALL REBUILT AS NEEDED

DISTRICT OF COLUMBIA  
DEPARTMENT OF TRANSPORTATION  
d.

EASTERN AVENUE N.E.  
FROM WHITTIER STREET N.W. TO NEW HAMPSHIRE AVENUE N  
SCALE: NONE DATE: SEPTEMBER 14, 2017

# Drainage Improvements

## ➤ Existing Drainage

- Inadequate stormdrain system (pre-1950's)

## ➤ Proposed improvements

- Use current design standards
- Double the number of inlets (20 NEW)
- Replace / Upsize damaged inlets
- Add stormwater management facilities
- Improve run-off flow
- Catch basins to separate sediments/trash
- Bio-retention planter to remove pollutants

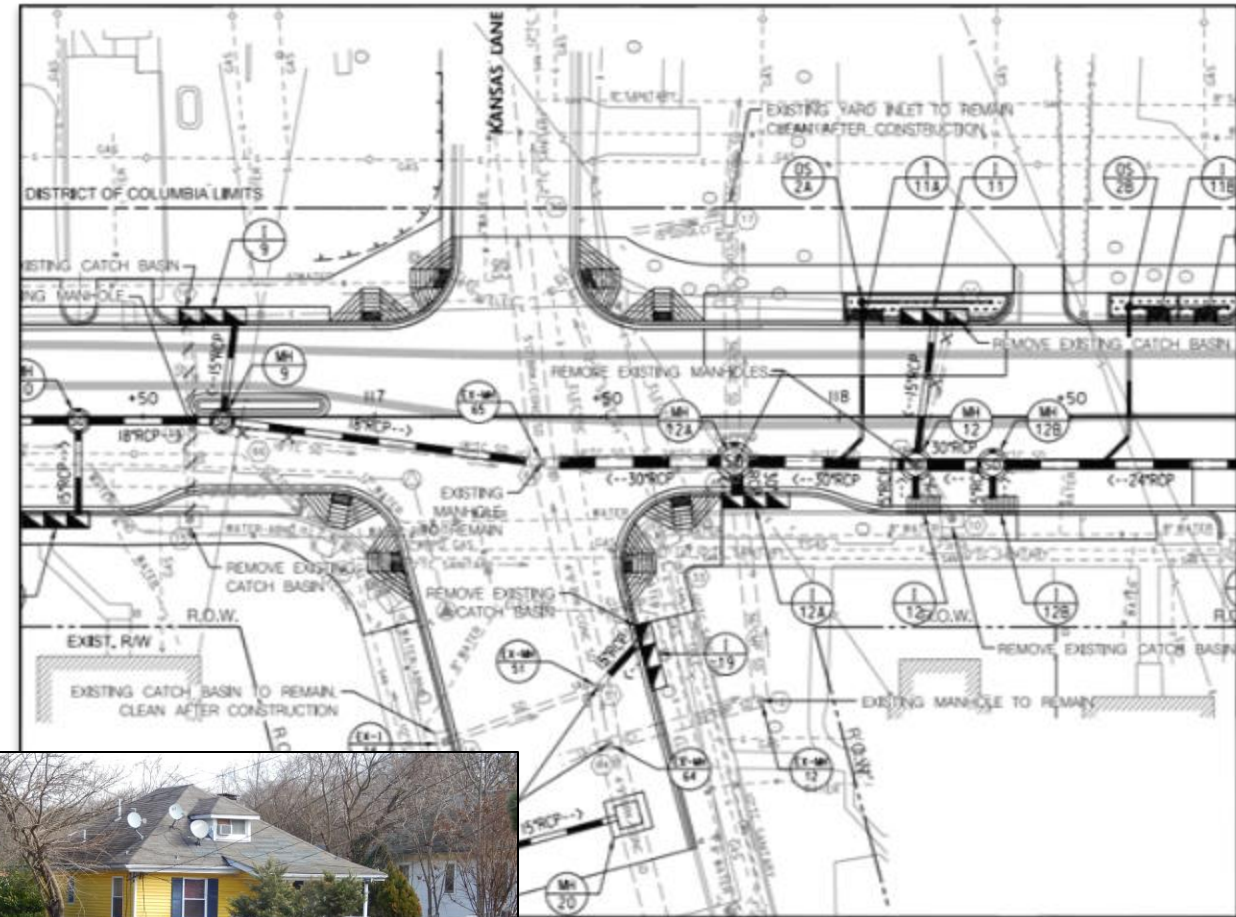



# Landscaping Improvements

## ➤ Existing Condition

- Dead and dying trees
- Unmaintained trees and shrubs
- Incorrect trimming / pruning to avoid overhead utilities

## ➤ Proposed improvements

- Replace dead and missing trees
- Pruning to preserve existing healthy trees
- Introduce NEW trees / planting areas

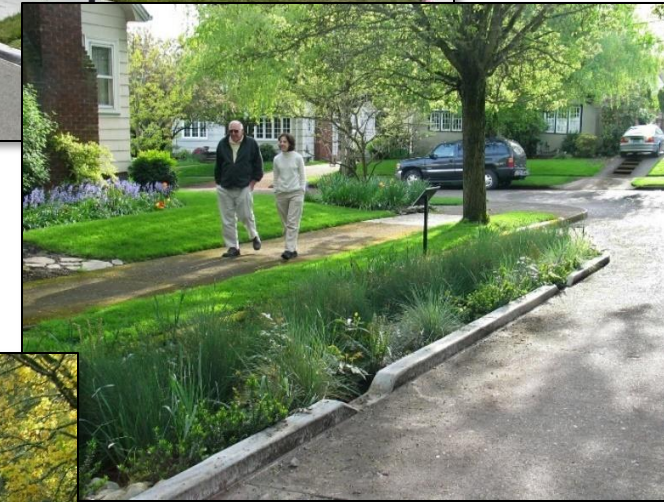
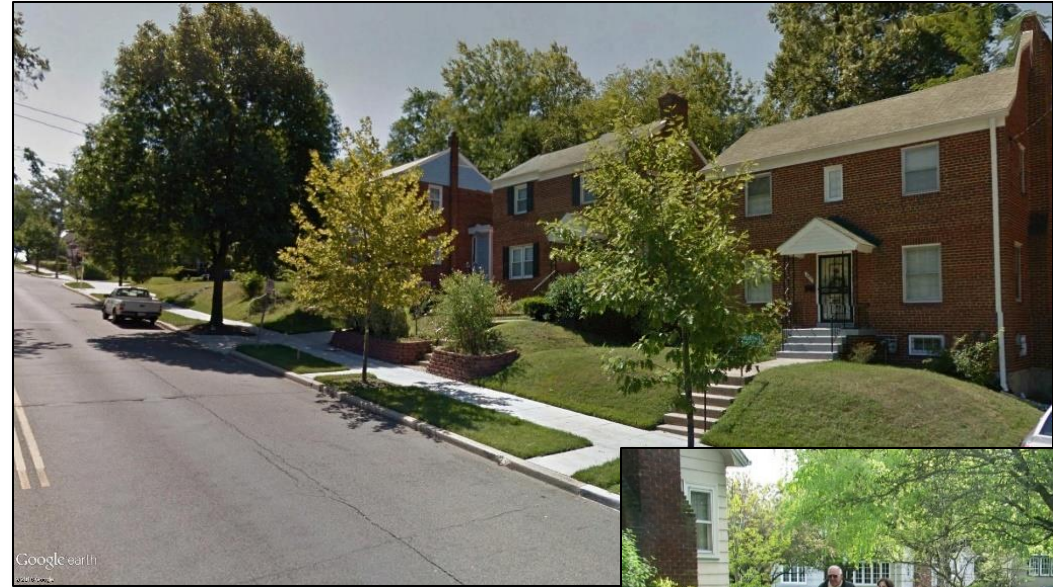

# Construction Phasing

## Goal

- Minimize traffic impacts (vehicles/peds/cyclists)
- Maintain traffic flow thru work zone and via Detours
- Maintain driveway access to businesses/residencies
- Minimize parking impacts
- Limit nighttime work
- Maintain safety of road user & construction worker

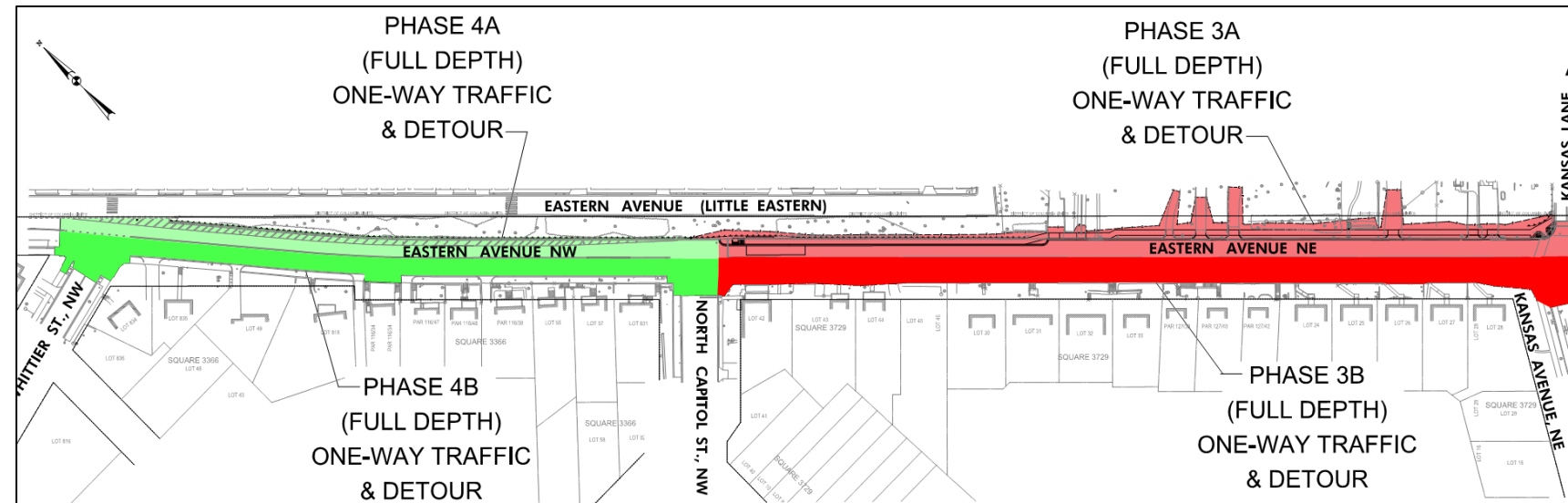
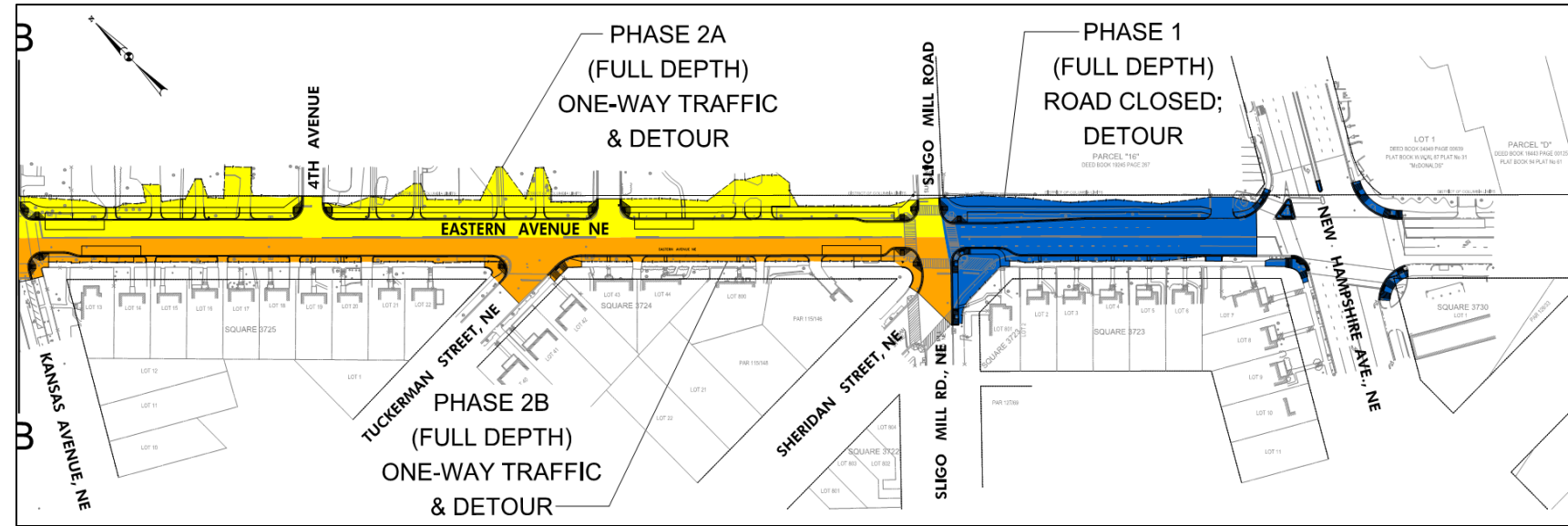



# Phase 1 Detour

## Road Full-Closure between New Hampshire Ave, NE and Sligo Mill Rd, NE

### SB Detour

- Sligo Mill Rd, NE
- Rittenhouse St, NE

### NB Detour

- New Hampshire Ave, NE
- Rittenhouse St, NE
- Kansas Ave, NE

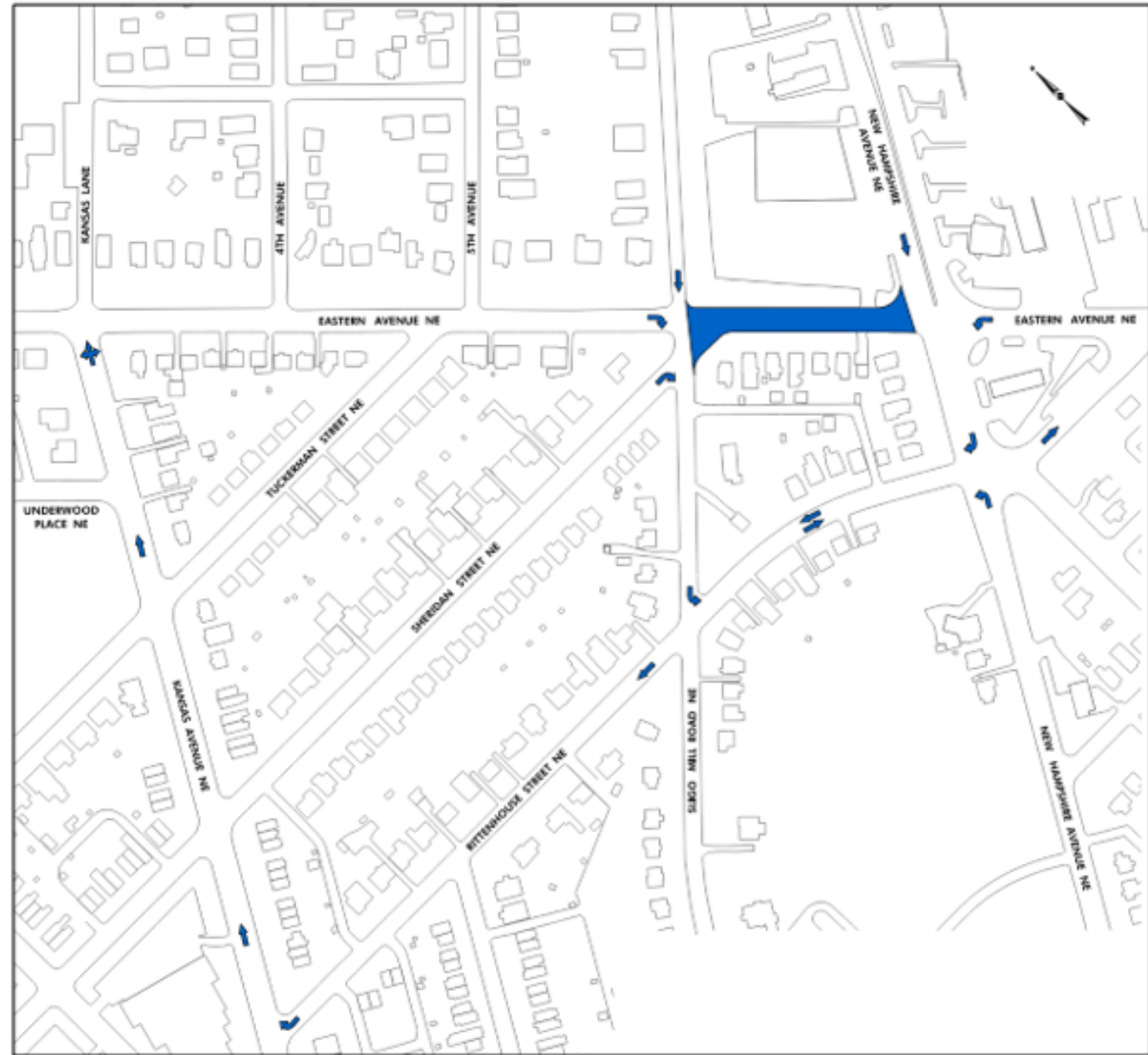

# Phase 2A Detour

**Road Partial-Closure (NB Eastern Ave, NE)  
between Sligo Mill Rd, NE and Kansas Ave, NE**

## NB Detour

- Sligo Mill Rd, NE
- Rittenhouse St, NE
- Kansas Ave, NE

## NB Detour (from 4<sup>th</sup> Ave / 5<sup>th</sup> Ave)

- Westmoreland Ave
- Kansas Ln

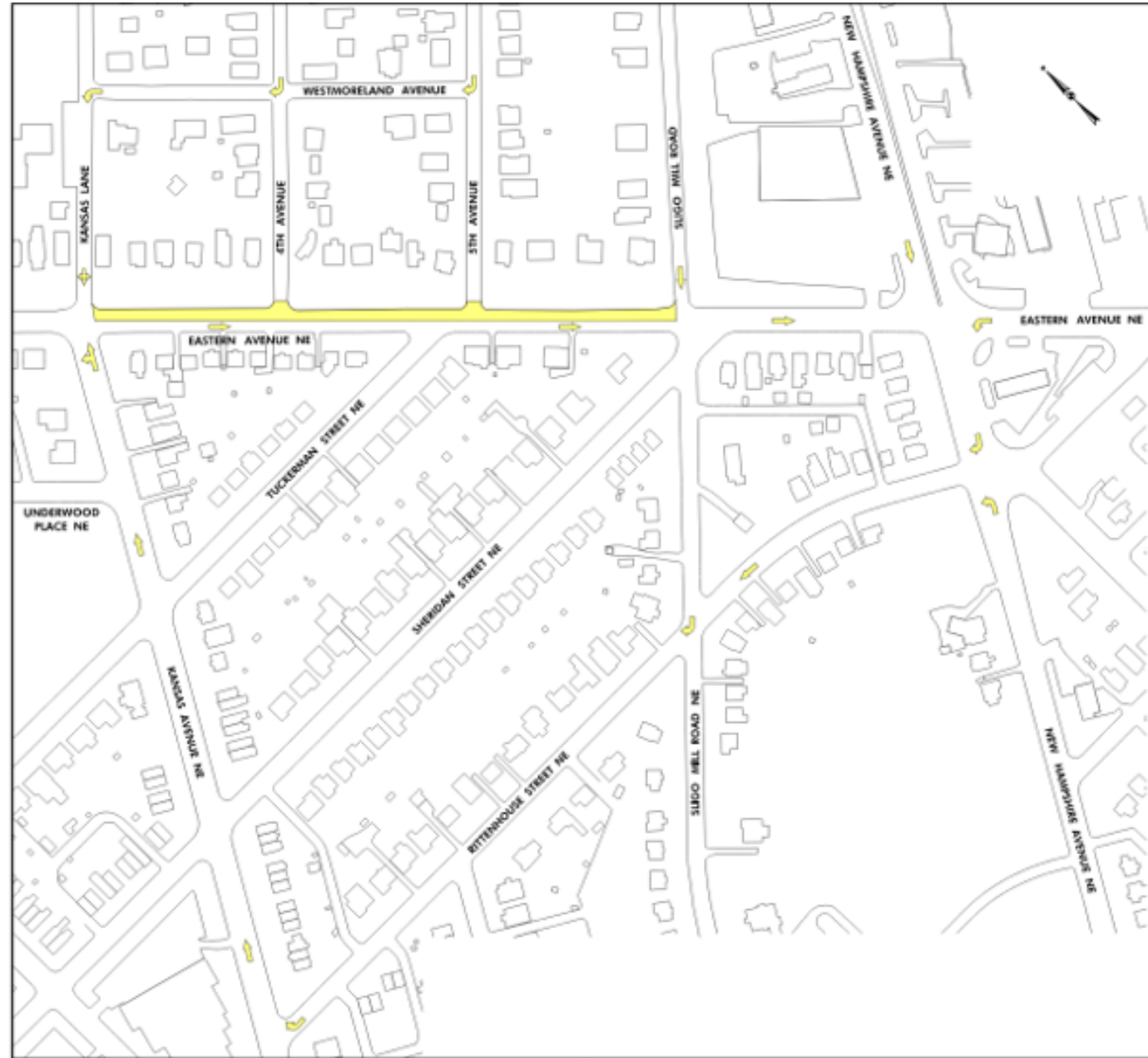

# Phase 2B Detour

Road Partial-Closure (SB Eastern Ave, NE)  
between Sligo Mill Road, NE and Kansas Ave, NE

## SB Detour

- Kansas Ave, NE
  - Sheridan St, NE to Sligo Mill Rd, NE
- Chillum Pl, NE
- Peabody St, NE
- New Hampshire Ave, NE

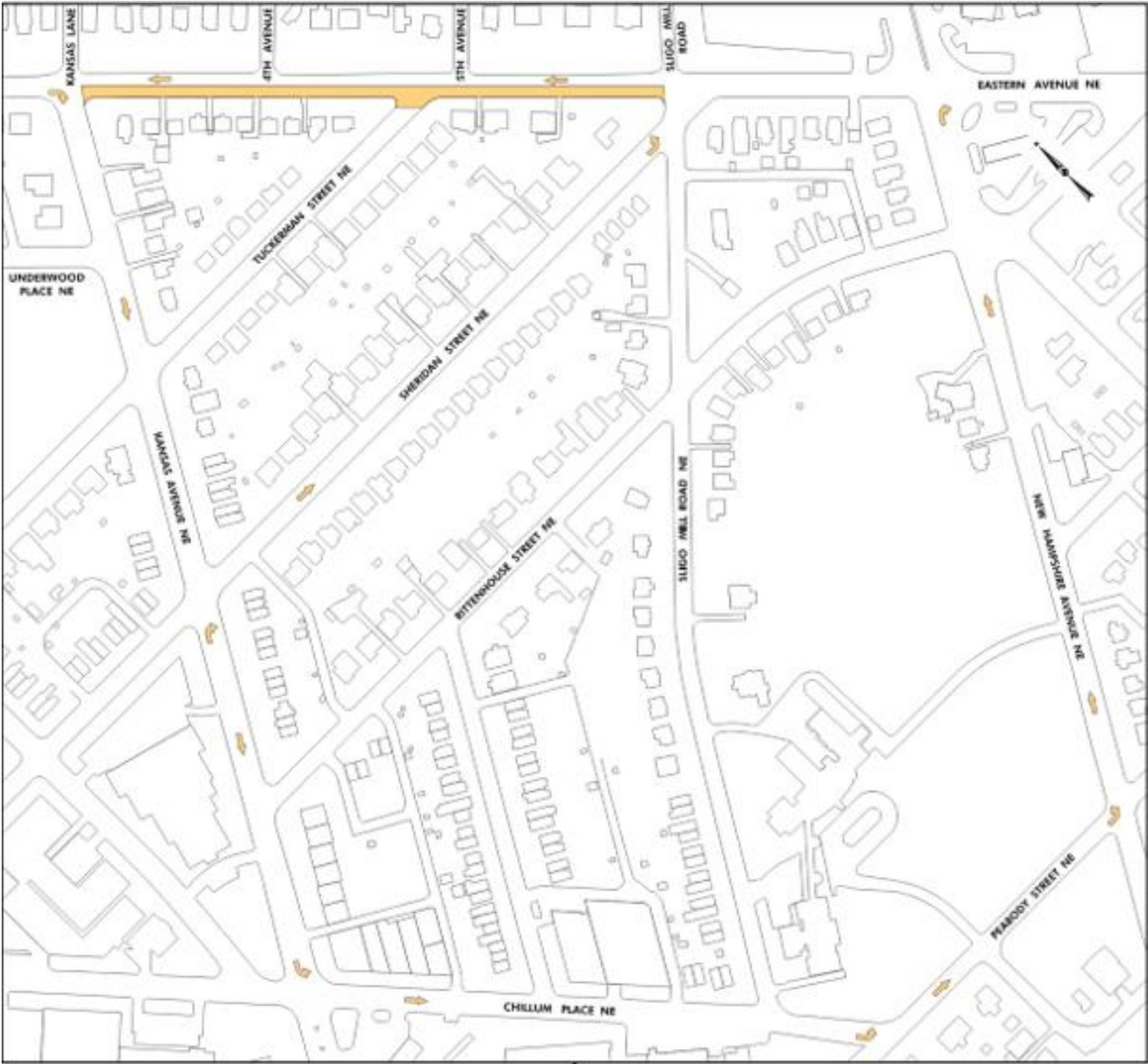



# Phase 3A Detour

## Road Partial-Closure (NB Eastern Ave, NE) between Kansas Ave, NE and N. Capitol St, NW

### NB Detour

- Kansas Ave, NE
- Underwood Pl, NE to N. Capitol St, NW
- N. Capitol St, NW

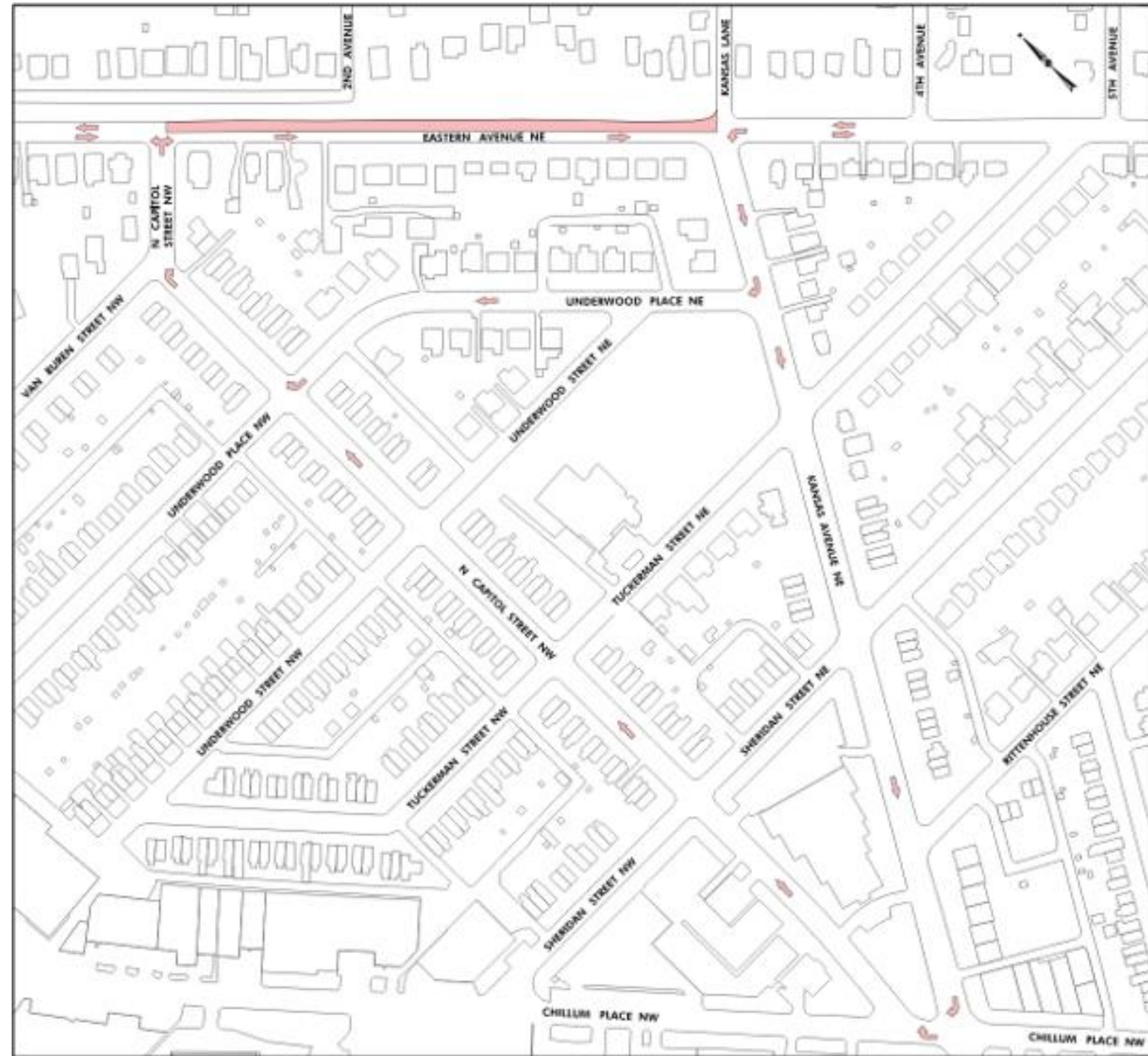

# Phase 3B Detour

**Road Partial-Closure (SB Eastern Ave, NE)  
between Kansas Ave, NE to N. Capitol St, NW**

**SB Detour**

- N. Capitol St, NW
  - Underwood Pl, NE to Kansas Ave, NE
- Kansas Ave, NE

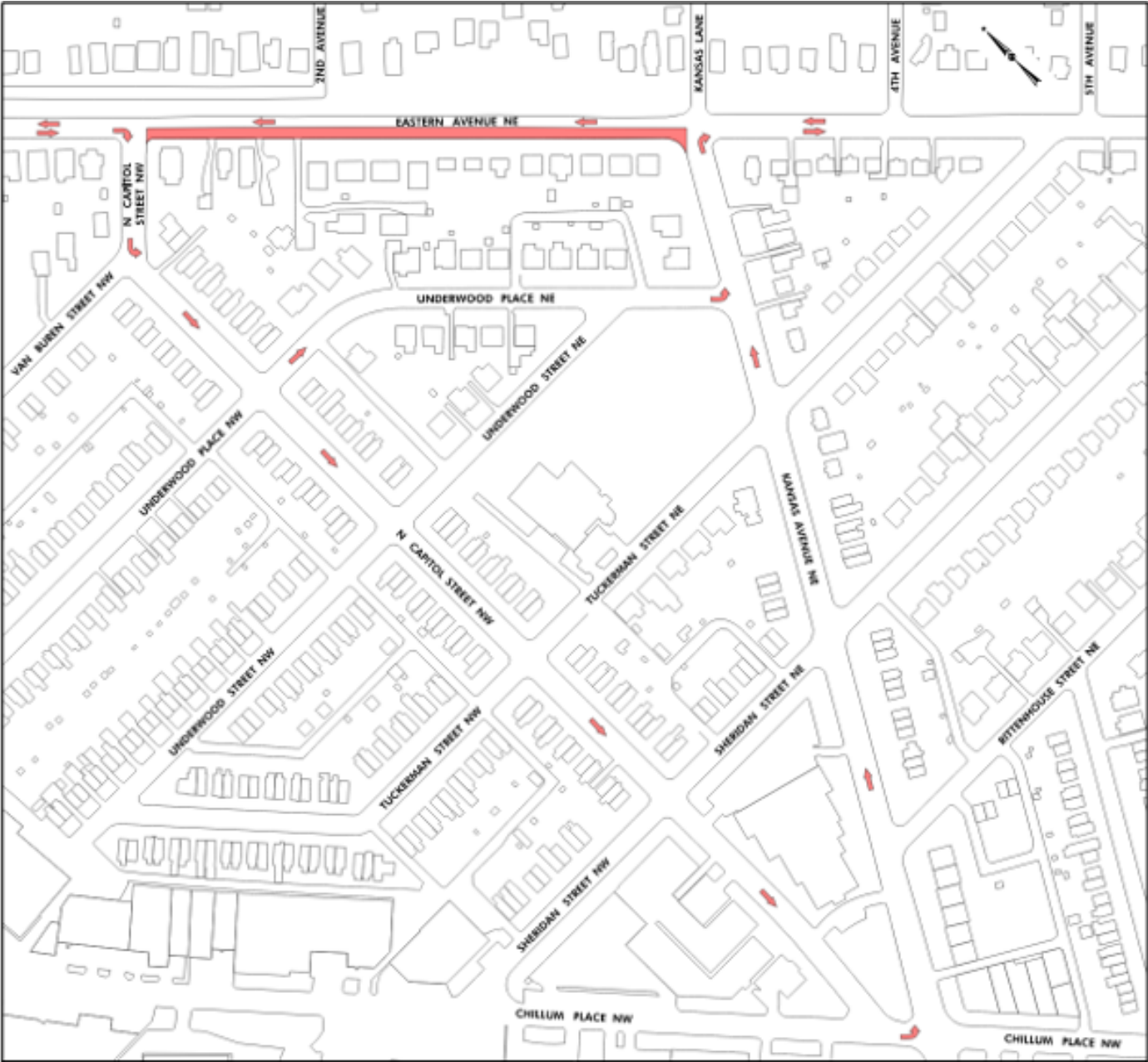

# Phase 4A Detour

## Road Partial-Closure (NB Eastern Ave, NE) between North Capitol St, NW and Whittier St, NW

### NB Detour

- N. Capitol St, NW
- Van Buren St, NW
- 1<sup>st</sup> St, NW
- Whittier St, NW
- 2<sup>nd</sup> St, NW
- Walnut St, NW





# Phase 4B Detour

## Road Partial-Closure (SB Eastern Ave, NE) between N. Capitol St, NW and Whittier St, NW

### SB Detour

- Walnut St, NW
- 2<sup>nd</sup> St, NW
- Whittier St, NW
- 1<sup>st</sup> St, NW
- Van Buren St, NW
- N. Capitol St, NW
- Sheridan St, NE
- Kansas Ave, NE



# Project Schedule

## ➤ Design Completion

- July 2022

## ➤ Construction Start

- Anticipated in FY2026, depending on Funding



## THANK YOU FOR YOUR ATTENDANCE

Additional comments can be submitted to DDOT Public Outreach Contact:  
Stacee Hemby, [stacee@tbaconnects.com](mailto:stacee@tbaconnects.com), 202-271-7406

Or emailed to the DDOT Project Manager:  
Tesfalem Aim, at [tesfalem.aim@dc.gov](mailto:tesfalem.aim@dc.gov)

**Project Webpage:** <https://ddot.dc.gov/page/rehabilitation-eastern-avenue-ne>



# Title VI – [rebrand.ly/CanalRoadNW-Comments](https://rebrand.ly/CanalRoadNW-Comments)

GOVERNMENT OF THE DISTRICT OF COLUMBIA  
DEPARTMENT OF TRANSPORTATION



Title VI Public Involvement Questionnaire

The District Department of Transportation is committed to providing all citizens, regardless of race, color, age, gender, or national origin, the opportunity to participate in and respond to transportation plans, programs, and activities that may affect their community. To help us make sure we are reaching our goal and maintaining compliance with Title VI of the Civil Rights Act of 1964 and all relevant federal and local nondiscrimination laws, we ask that you voluntarily complete the following information. DDOT's Title VI Coordinator will handle the information you provide with confidentiality. For more information regarding DDOT's Title VI Program, please contact DDOT's Transportation Equity and Inclusion Division at 202.671.2700 or [ddot@dc.gov](mailto:ddot@dc.gov).

Project/Meeting Name & Date

☐ Canal Road Rock Slope Stabilization Project, August 4, 2021

Was this meeting held at a convenient time?

☐ Yes

☐ No

Next

As a recipient of Federal assistance, DDOT must ensure that all of its programs, activities and public meetings are conducted in compliance with Title VI of the Civil Rights Act of 1964. This Act ensures nondiscrimination based on race, color or national origin. The Title VI Public Meeting Participant Questionnaire is used to help DDOT ensure that we are informing the public and conducting our meetings in a nondiscriminatory manner, in compliance with Title VI.



Project comments and/or concerns may also be submitted through this form. We appreciate anyone who is willing to complete the form.

Thank you for your participation.



---

District Department of Transportation